

Parts List and Diagram for Morse Part # M404-P Power Pack

Used on: **400 Series Hydra-Lift Karriers with Serial Number 0981 to 1102 (MMYY)**
405 Series Omni-Lift Drum Rackers with Serial Number 0981 to 1102 (MMYY)
500 Series Vertical-Lift Drum Pourers with Serial Number 181180 to 203699

ITEM	QTY.	PART #	DESCRIPTION
1	1	*****	SEE FIGURE 1
2	1	M01139-P	COUPLING HALF 5/8" BORE MON
3	1	M01603-P	SPIDER, COUPLING, MON
4	1	M01189-P	COUPLING HALF 1/2" BORE MON
5	4	M07818-P	SHCS, 1/4-20 X 3
6	4	M07817-P	HHCS, 3/8-16 X 7/8
7	1	M01615-P	HOUSING, PUMP/ MOTOR ADAPTER
8	1	M02637-P	PUMP ASM, GEAR CODE 43 MON
9	1	M00075-P	KIT, MAIN CHECK VALVE PARTS
10	1	M02222-P	KIT, RELIEF VALVE PARTS, MON
11	1	M02352-P	O-RING, 3-5/8 X 3-7/8 X 1/8
12	1	M01117-P	NIPPLE, 3/8 NPT X 2" MON
13	1	M01122-P	ELBOW, 90DEG, 3/8 NPT
14	1	M01459-P	TUBE, SUCT, FILTER, 3/8 NPT
15	1	M01134-P	FILTER SCREEN, SUCTION MON
16	1	M01274-P	TUBE, RETURN, 1/8" NPT
17	1	M01303-P	ELBOW ASM, BRASS W/ RETURN NIP
18	1	M06899-P	RESERVOIR, 6" DIA X 9" MON
19	1	M01143-P	PLUG, BREATHER, FILLER MON
20	6	M07703-P	SCREW, 10-24 X 3/8 TF
21	1	M13304-P	TUBE, RETURN, VALVE, M404 MON
22	2	M01225-P	ELBOW, RETURN, MON
23 *	2	M01157-P	BALL, PLASTIC, HANDLE, MON
24 *	2	M01326-P	ROD, VALVE HANDLE, MON
25	2	M00173-P	HANDLE BASE, MON
26	2	M00172-P	HANDLE ASM, W/ BASE, MON
27	4	M07780-P	WASHER, 5/16" SPECIAL, MON
28 *	2	M00018-P	SPRING, TORSION, MON
29	2	M00016-P	BUSHING, TORSION SPRING, MON
30	1	M01318-P	ADAPTER, PUMP/ VALVE, 2-1/2"
31	1	M07187-P	VALVE, 3-4 WAY ROUND ROUND
32	1	M404-P	HYDRAULIC POWER PACK, -110, -114

* Recommended spare parts



morsedrum.com



service@morsedrum.com



(315) 437-8475



103 Kuhn Rd.
Syracuse, NY, 13208 USA

Parts List and Diagram for Morse Part # M404-P Power Pack

Used on: 400 Series Hydra-Lift Karriers with Serial Number 0981 to 1102 (MMYY)
405 Series Omni-Lift Drum Rackers with Serial Number 0981 to 1102 (MMYY)
500 Series Vertical-Lift Drum Pourers with Serial Number 181180 to 203699

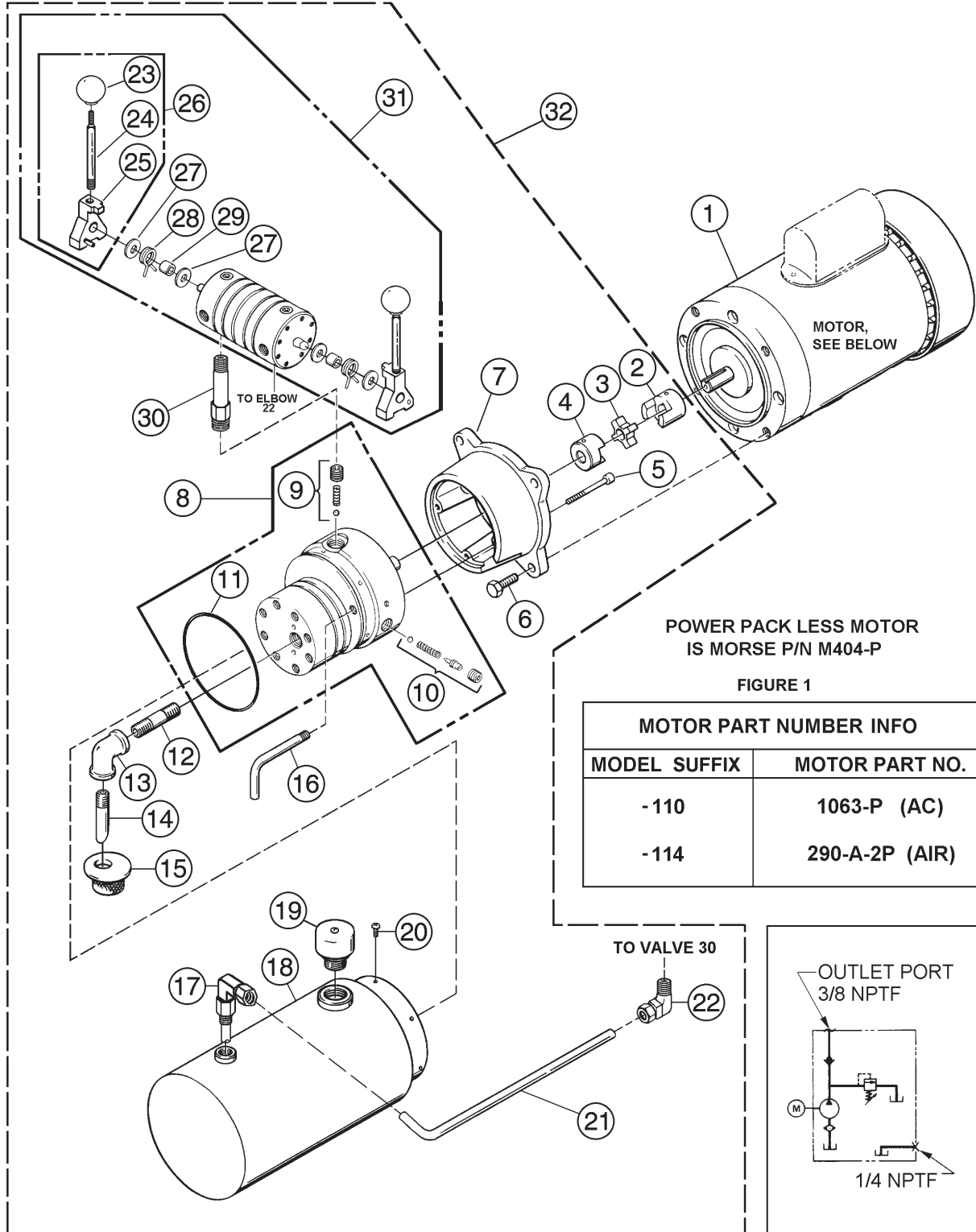

Maintenance for Hydraulic Power Pack

Maintenance info for Hydraulic Pump

Recommended oil is petroleum based Dexron III ATF or equivalent (non-synthetic).
Change oil yearly.

Recommended Operating Conditions:

- Oil Temperature Range: 10°F to 170°F (-25°C to 77°C)
- Operating Temperature: 50°F to 130°F (10°C to 54°C)

Oil Viscosity:

- Optimum 100 to 350 SUS (Cst = .22 X SUS – 135/SUS)
- Minimum 100 SUS at Operating
- Maximum Start Up 4000 SUS

Recommended Filtration:

- 10 micron nominal or better

The system should not be disassembled in the field for maintenance. These are pass or fail components.

If the valve or pump fails it will need to be replaced due to wear on components.

The root cause for the failure needs to be taken into account to avoid contaminating the new components or to avoid exposing them to the same fail parameters.