

Option POLY-201FI

Kit for field installation to roll plastic drum on Morse 201 Series Portable Drum Rollers

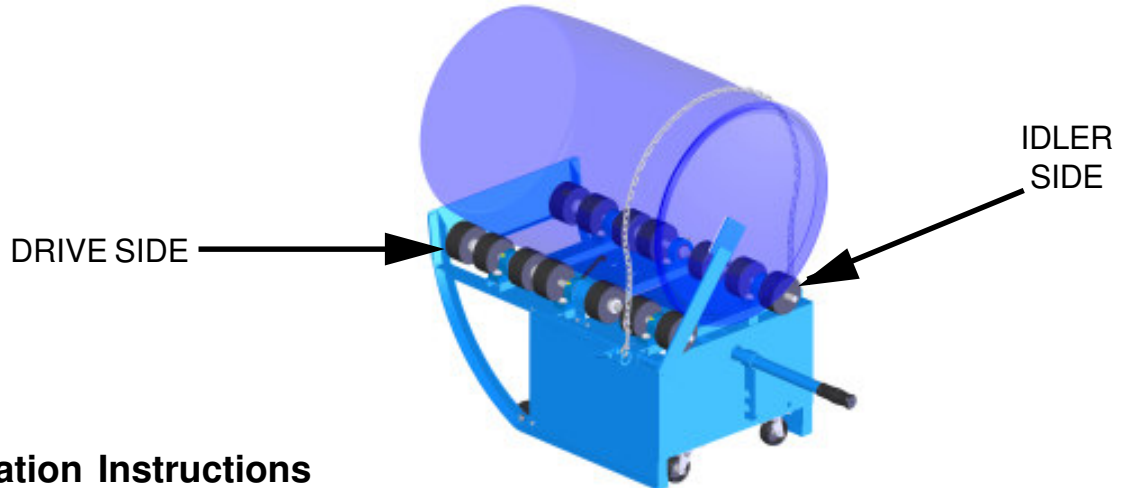

Installation Instructions

Before you begin, mark the frame at all six pillow block bearing bases to locate factory set position.

Idler Shaft Assembly

1. Remove the six bearing bolts on the idler side.
2. Loosen the set screws and remove the wheel from each end of the assembly.
3. Loosen the set screws and remove the pillow block bearings from each end of the assembly. This will leave only the center bearing and a wheel on each side of it.
4. Add one wheel to each end to make two wheels on each side of the center bearing. Do not tighten any set screws at this point.
5. Reinstall the two bearings on the shaft and then the two outside wheels.
6. Add the seventh wheel to the end closest to the loading plate.
7. Set the idler shaft assembly on the frame into the position where the frame was marked.
8. Reinstall bearing mounting bolts and nuts and tighten in place.

Drive Shaft Assembly

1. Remove drive sprocket cover
2. Remove the six pillow block bearing bolts.
3. Remove master link from drive roller chain and take chain off sprocket.
4. Remove drive shaft assembly and repeat wheel install procedure from above (step 2 through 6)
5. Set the drive shaft assembly on the frame into the position where the frame was marked.
6. Install all bearing mounting bolts and hand tighten the nuts, except the outside bolts on the two bearings where the back stop tube assembly will be mounted (see diagram).
7. Reinstall drive roller chain.
8. Insert the back stop tube as shown, and secure with 3/8-16 x 1-1/2. bolts provided in kit. These should be hand tight at this point.
9. While ensuring that the drive roller chain is tight, tighten the bearing bolts. The bearings should be at the factory positions that were marked on the frame.

Final Assembly

1. Insert loading chain eye bolt in blank hole on idler side as shown. Secure with two nuts and two washers.
2. Adjust all wheels and tighten all set screws.

Option POLY-201FI
Kit for field installation to roll plastic drum on Morse 201 Series Portable Drum Rollers

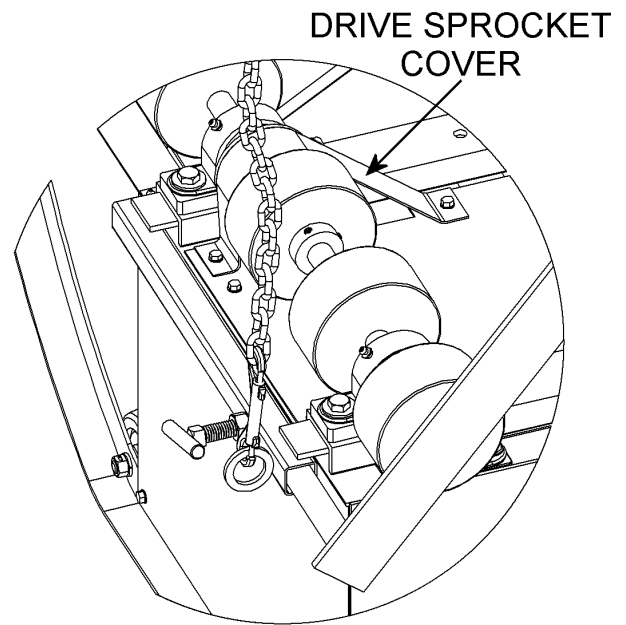
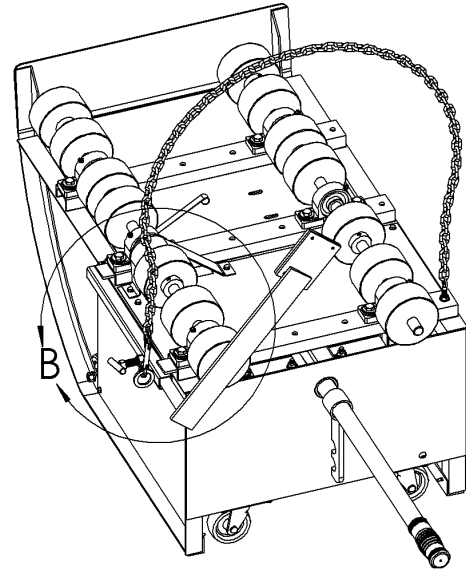
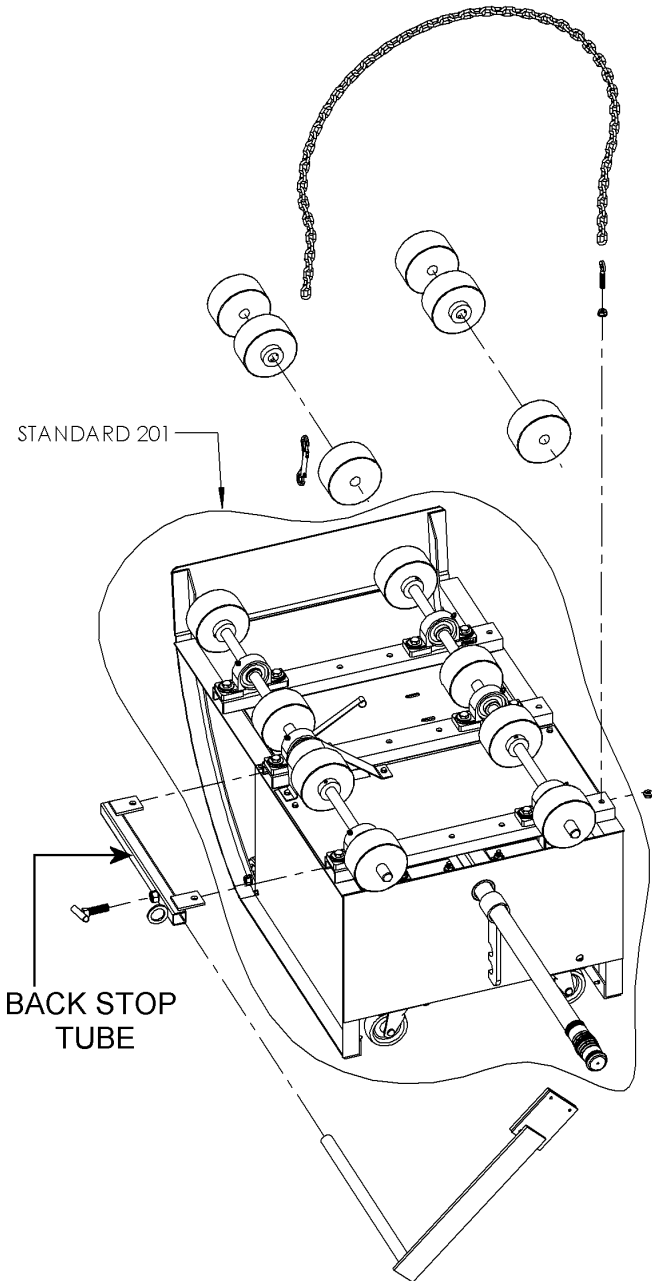

DETAIL B
 SCALE 1 : 5

Option POLY-201FI

Kit for field installation to roll plastic drum on Morse 201 Series Portable Drum Rollers

ITEM	QTY.	PART #	DESCRIPTION
1	1	575-P	SNAP HOOK, GR, 300
2	1	202-P	WHEEL, DRIVE OR IDLER, 4", 201
3	1	3988-P	CHAIN, 1/0 LOCK LINK, 66"
4	2	1634-P	NUT, 5/16-18 WHIZ LOCK
5	1	248-P	FHMS, 10-24 X 3/8
6	1	327-P	WEAR PAD, UHMW, TIVAR, 201B
7	1	3501-P	BACK STOP LEVER WELD, 201
8	1	1372-P	TEE HANDLE, HDPS, 1-1/2"
9	1	3499-P	BACK STOP TUBE WELD, 201
10	1	3281-P	HHCS, 3/8-16 X 1-1/2
11	1	1869-P	NUT, 10-24 NYLON LOCK
12	4	3292-P	WASHER, SAE #10, ID3/16"OD7/16
13	1	1867-P	BHSC, 10-24 X 1-1/2
14	1	M01327-P	BOLT, 5/16-18 X 1-7/8 EYE, MON

For replacement parts, please contact your Morse dealer.

When ordering parts, please specify:

- Part number and description,
- Model number
- Serial number

Find model number and serial number on metal name plate attached to frame.

Option POLY-201FI
Kit for field installation to roll plastic drum on Morse 201 Series Portable Drum Rollers

