



MORSE 

82H SERIES

SPECIFICATIONS SHEET

DRUM MOVERS & PALLETIZERS



82H Series Move & Palletize Upright Drums

- Efficiently move upright drum onto and off pallets and floor
- Handle virtually any rimmed steel, fiber or plastic drum up to 1000 Lb. (454 kg)
- Drums may be tight head or removable top securely clamped in place
- Handle drums of various diameters
- Requires drum at least 22.5" (57.15 cm) tall
- Requires 75 Lb. (34 kg) minimum drum weight to activate jaws
- Raise a 34-7/8" (88.6 cm) tall drum up to 19" (48.3 cm) above the floor. Heavy duty hydraulic lift cylinders include a velocity fuse to provide a full line shut-off in the event of a line failure.
- Models available with ergonomic battery, electric or air power lift
- Completely mechanical automatic drum grip
- Precision mechanism is built to last with wide jaws for secure grip

Grab, Lift And Move Drum In Minimum Time With This Efficient Drum Handler.



Drum gripping jaws in the "head" provide automatic hold to carry your drum in vertical position. The gripping action is completely mechanical and automatic. With the "head" containing the jaws below the level of the drum rim, simply press Model **82H** against the drum, raise the "head" to engage the grip and lift drum. Move your drum to the desired location. The jaws release when drum is set down on floor or pallet.

Jaws grip the upper rim of a plastic, steel or fiber drum weighing up to 1000 Lb. (454 kg). Models **82HM** and **82HM-124** have spark resistant parts, such as the back rest and head with jaws (shown right).





82H SERIES

Drum Movers & Palletizers

SPECIFICATIONS SHEET

82H SERIES MODELS				
MODEL	DRUM HOLDER	FEATURES	MOTOR TYPE	MOTOR CONTROL
82H	Jaws and brace on sidewall	Hand Pump Lift	--	--
82H-120	Jaws and brace on sidewall	AC Power Lift	1PH/115V/60Hz, TEFC	Switch, cord and plug
82H-124	Jaws and brace on sidewall	Air Power Lift	Air Valve	On / Off valve
82H-125	Jaws and brace on sidewall	Battery Power Lift *	12V DC *	Built-in
82HM	Jaws and brace on sidewall	Spark resistant parts, Hand Pump Lift	--	--
STAINLESS STEEL MODELS - MADE OF TYPE 304 STAINLESS STEEL WITH BEAD BLAST FINISH				
82HM-124	Jaws and brace on sidewall	Spark resistant parts, Air Power Lift	Air Valve	On / Off valve
82H-SS	Jaws and brace on sidewall	Stainless Steel, Hand Pump Lift	--	--
82H-SS-120	Jaws and brace on sidewall	Stainless Steel, AC Power Lift	1PH/115V/60Hz, TEFC	Switch, cord and plug
82H-SS-124	Jaws and brace on sidewall	Stainless Steel, Air Power Lift	Air Valve	On / Off valve
82H-SS-125	Jaws and brace on sidewall	Stainless Steel, Battery Power Lift *	12V DC *	Built-in

* 12V DC Power Lift includes 12V deep cycle battery, and 100/220V 50/60Hz AC charger.

DIMENSIONS	
Overall Width	48.5" (123.2 cm)
Overall Length	43" (109.2 cm)
Turning Radius	53" (135 cm)
Leg Height	9" (22.9 cm)
Leg Reach	20.75" (52.7 cm)
Swivel Casters At Back	(2) 4" (10.2 cm)
Wheels At Front	(2) 6" (15.2 cm)
NOTE: A 55-gallon (210 liter) steel drum extends 11.75" (29 cm) beyond the front wheels	

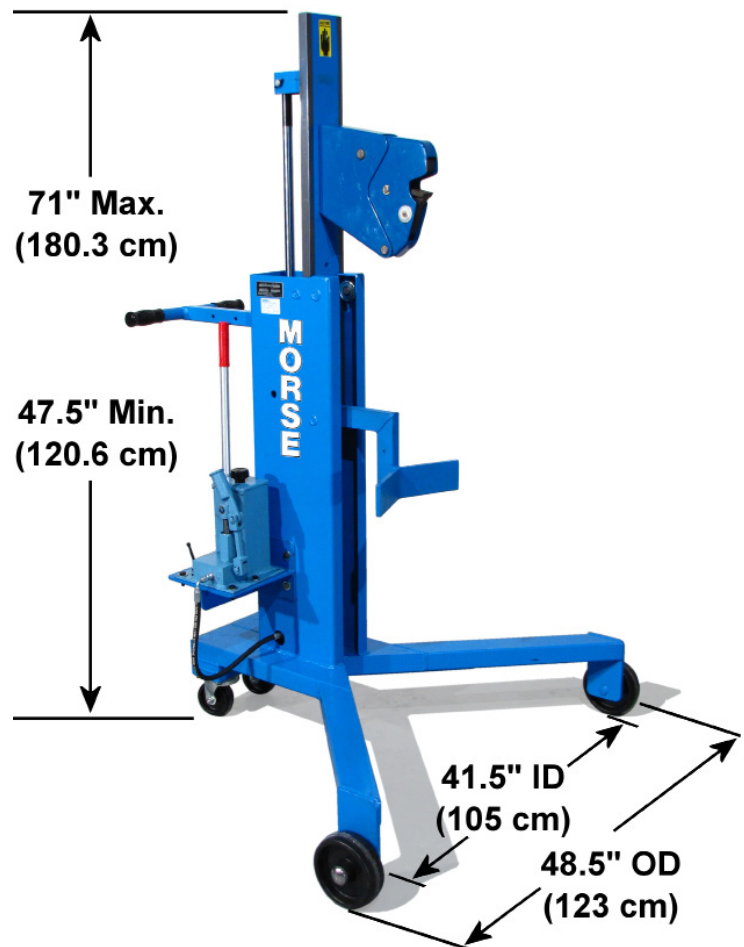



82H SERIES

Drum Movers & Palletizers

SPECIFICATIONS SHEET

Electric Lift Controls Model 82H-120

Use switch to raise the drum. Lower the drum with manual release valve.

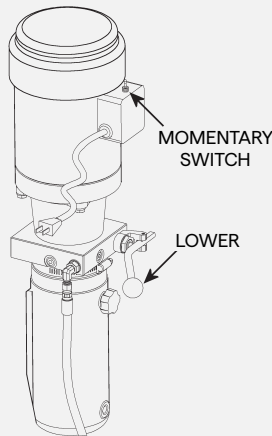

Battery Power Lift Controls Model 82H-125

Self contained battery power-lift. Use valve to raise and lower the drum. 12V deep cycle battery and separate charger are included.

NOTE: 12V Deep Cycle Lead Acid Battery is designed for domestic shipment only.

For export shipment, choose Option "NB" No Battery. Customer must obtain battery before use. Exide # 27MDP 12V Deep Cycle Battery or equivalent.

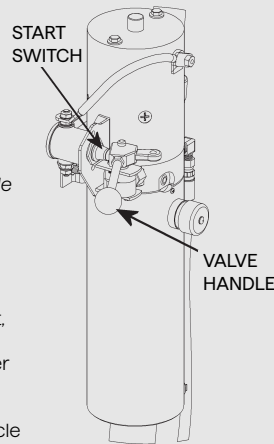

Air Power Lift Controls Models 82H and 82HM-124

Use on / off valve to raise and lower the drum. Plant Air Pressure Required to Lift Drum:

- 100 PSI to lift 1000 Lb. (454 kg) drum
- 80 PSI for 800 Lb. (363 kg) drum
- 60 PSI for 600 Lb. (272 kg) drum
- 40 PSI for 400 Lb. (181 kg) drum

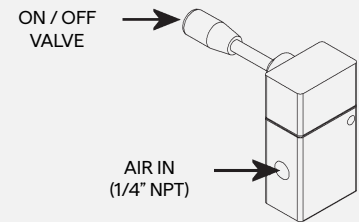

Manual Hand Pump Lift Models Models 82H and 82HM

These models require 27 pumps of the hand pump to lift a drum to maximum height.



Model # 82HM

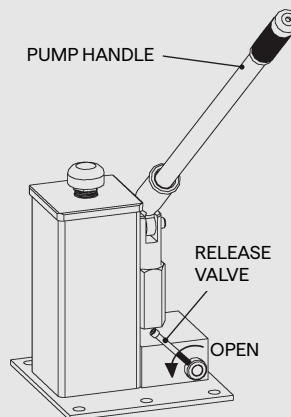

Model # 82H



82H SERIES

Drum Movers & Palletizers

SPECIFICATIONS SHEET

Bolt the Head to the Riser in Position A, B or C

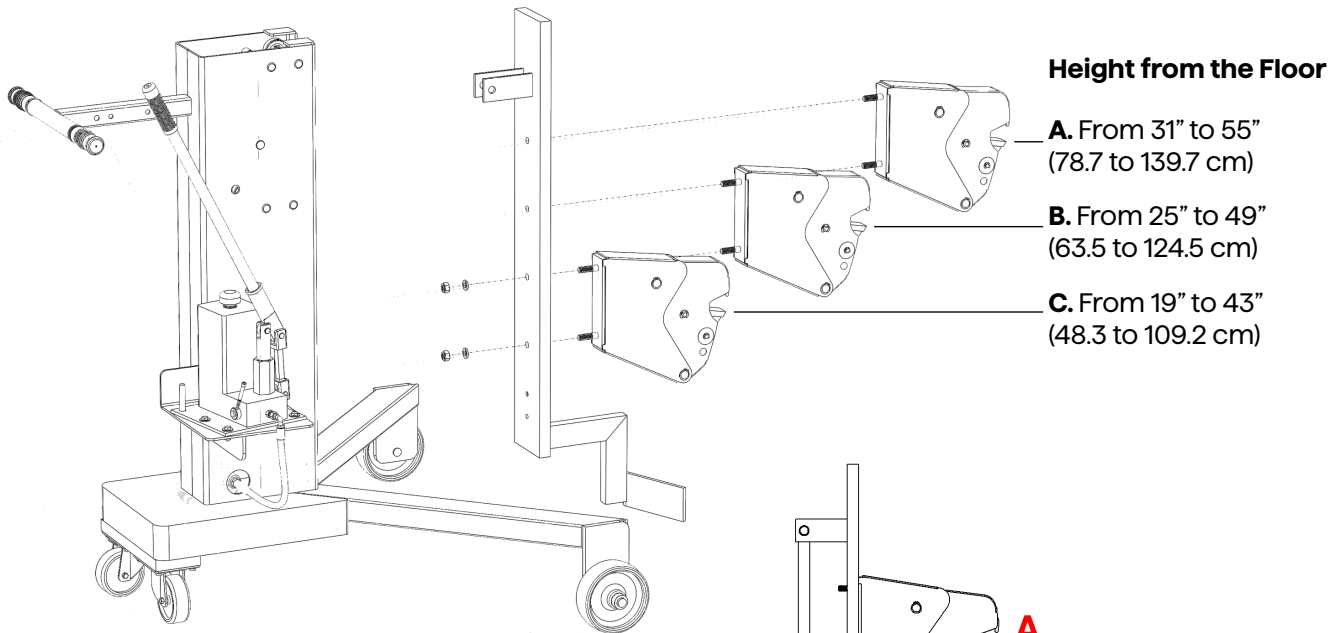

Height from the Floor

A. From 31" to 55"
(78.7 to 139.7 cm)

B. From 25" to 49"
(63.5 to 124.5 cm)

C. From 19" to 43"
(48.3 to 109.2 cm)

NOTE: A 55-Gallon (210 Liter) Steel Drum
Extends 11.75" (29 cm) Beyond Front Wheels

